

AR Series

Hydraulic Impact Breaker

Model
AR120B

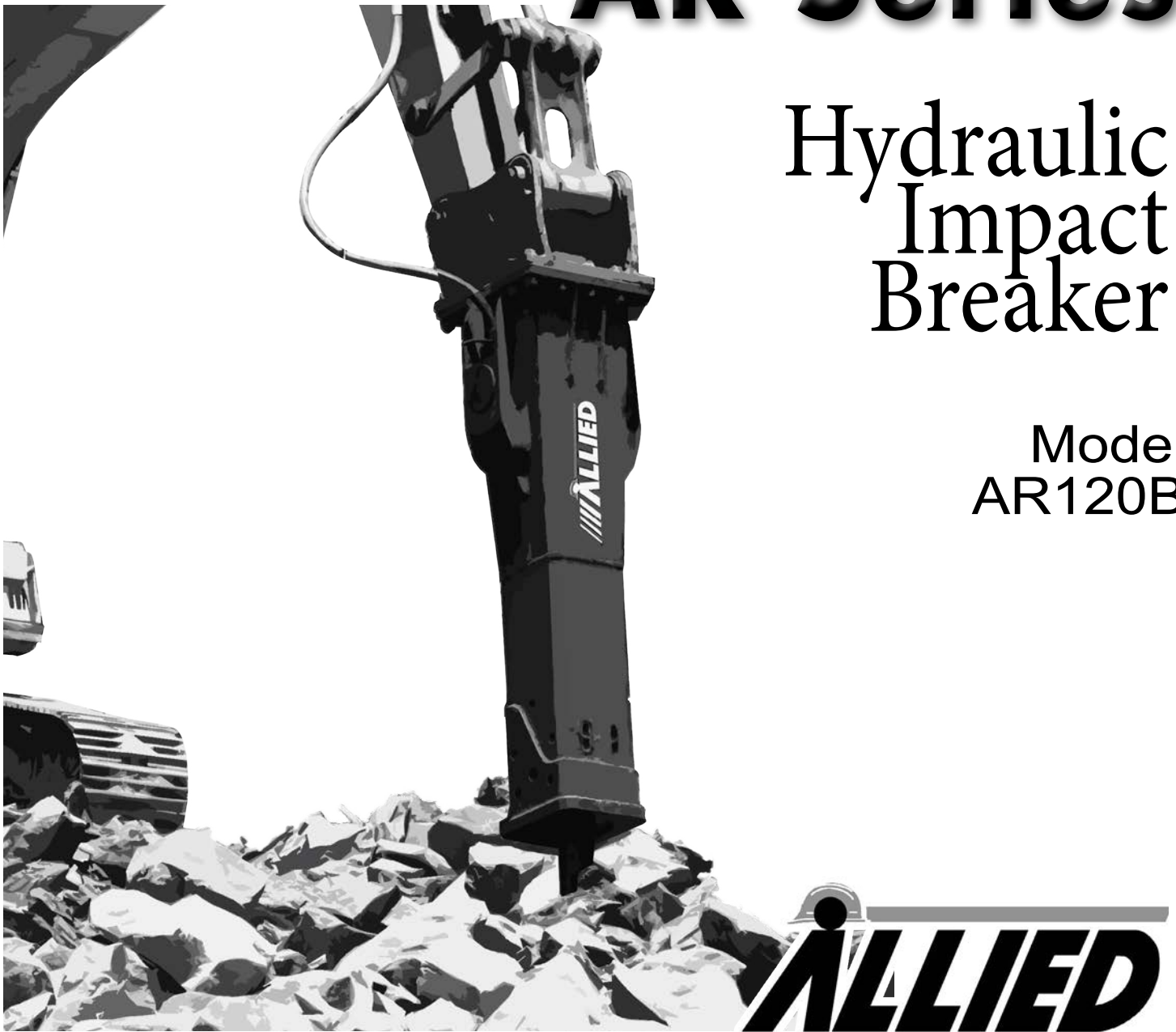

Parts Manual - AR120B

Keep this manual in a convenient location so that it is easily accessible for future reference. Contact your Allied Dealer or the Allied Customer Service Department for replacement manuals. Inquiries regarding the content of this manual must include effective date shown on inside cover.



PM572403



3900 Kelley Ave
 Cleveland, Ohio 44114
 E-mail: sales@alliedcp.com

Contact Information

Tel: 216-431-2600
 Fax: 216-431-2601

Continuous improvement of our products is an Allied policy. The material in this publication, including figures, captions, descriptions, remarks and specifications, describe the product at the time of its printing, and may not reflect the product in the future. When changes become necessary, these will be noted in the table below. Specifications are based on published information at the time of publication. Allied Construction Products, LLC, reserves the right to change, edit, delete or modify the content of this document, including descriptions, illustrations and specifications without prior notification. For product or document updates go to www.alliedcp.com.

Table of Revision History for Document No. PM572403

<u>Effective Date</u>	<u>Page</u>	<u>Summary of Change</u>
14 Dec	7	Revise Item 215 part number change
13 Dec	7	Revise Parts Table 4.1
13 Aug	All	Update overall format, illustrations, parts tables
08 Feb	4	Revise hose connection configuration
07 Oct	4 & 8	Revise hose connection part numbers
07 Aug 28	5 & 6	Revise housing ass'y
07 Aug 09		Revise Tune-up Kit
06 Nov		Original Issue of 572403

Table of Contents

<u>Section</u>	<u>Page</u>
Contact Information.....	i
Document Revisions.....	i
Table of Contents.....	ii
1.0 Introduction & Scope.....	1
1.1 Purpose of This Manual.....	1
1.2 About This Manual.....	
1.3 How to Order Replacement Manuals.....	1
1.4 Related Publications.....	1
2.0 Equipment Identification.....	3
2.1 Serial Number Location.....	3
2.2 Equipment Identification Tag.....	3
2.3 Owner's Record of the Equipment.....	3
3.0 Safety & Information Labels.....	4
4.0 Identification of Spare Parts.....	7
4.1 Housing Box and Components.....	7
4.2 Breaker Assembly.....	9
4.3 Hydraulic Connections.....	15
5.0 Tool Selection Guide.....	16
5.1 Standard Tools.....	16
5.2 Specialty Tools.....	16
5.3 Chisel Paste.....	17
6.0 Service Kits and Tools.....	18
6.1 Tune-Up Kit.....	18
6.2 Seal Set.....	19
6.3 Accumulator N2 Gas Charge Tool Kit...	21
7.0 Mounting to the Carrier.....	22
7.1 Mounting Brackets.....	22
8.0 How To Order Spare Parts.....	23

<u>List of Figures</u>	<u>Page</u>
2-1 Equipment ID Tag Location.....	3
2-2 Equipment Identification Tag.....	3
3-1 thru 3-14 Safety & Information Labels.....	4
3-15 Location of Labels on Equipment.....	6
4-1 Housing Box & Components.....	7
4-2 Breaker Assembly.....	9
4-3 Hose Routing To Excavator – Typical....	15
4-4 Hydraulic Connections.....	15
5-1 Standard & Specialty Tools.....	16
5-2 Tool Diameter & Working Length.....	17
6-1 Tune-up Kit.....	18
6-2 Seal Set.....	19
6-3 Accumulator N2 Gas Charge Tool Kit....	21
7-1 Mounting Bracket - Typical	22
7-2 Mounting Connection Plate Family.....	22

1.0 Introduction and Scope

1.1 Purpose of This Manual

The material in this manual has been prepared in support of the product named in Table 1.1. It's intended solely for use with the product identified in Table 1.1 and may not be suitable for other models.

Materials presented in this manual, including figures, captions, descriptions and parts tables may show equipment that is optional. Figures depict views that are intended for parts identification and not for purposes of repair or service of the product. Parts Manuals do not include safety precautions or procedures for operation.

How to use this Manual:

- Assembly components are identified with the aid of figures, figure captions, item key, part name and quantity. When necessary, remarks and specifications further enhance part description.
- To assist you, a parts order form is provided at the back of this manual

Prior to ordering parts, confirm that the information recorded on the equipment's identification label corresponds with Table 1.1. For the location of this label, refer to Section 2.0 of this manual.

Table 1.1 About This Manual



Document ID. No.	PM572403
Type	Spare Parts
Current Status	See Inside Cover
Product Name:	Mounted Hydraulic Impact Breaker
Series	AR
Applicable Model[s]:	AR120B
Years of Manufacture:	Begin 2006
*Inquiries regarding this manual must include effective date shown on inside cover	

The document, identified in Table 1.1, is published solely for information purposes and should not be considered all-inclusive. If further information is required, contact your local Allied dealer or the Allied Customer Service Department.

The content of this document has been reviewed for accuracy. Allied Construction Products, LLC has endeavored to deliver the highest degree of accuracy and every effort has made to provide information as complete as possible. However, continuous improvement of our products is an Allied policy. The material in this publication, including figures, captions, descriptions, remarks and specifications, describe the product at the time of its printing, and may not reflect the product in the future. A summary of changes made to the content of this document can be found on the inside cover of this manual.

1.2 How To Order Replacement Publications

This manual is an integral part of this product. Keep it in a convenient location so that it is easily accessible for future reference.

Replacement manuals can be ordered by contacting your Allied dealer service center. These manuals may also be viewed and downloaded at: www.alliedcp.com

1.3 Related Publications

Allied Construction Products, LLC offers the following publications for the product identified in Table 1.1.

1.3.1 Safety, Operation & Maintenance Manual

SOM576701 for AR-Series AR110C – AR140B

The Safety, Operation and Maintenance Manual has been prepared to assist the operator and maintenance personnel with the information necessary for the safe and proper use of the Allied work tool.

Content includes:

Safety Information
 Equipment Serial Number and Model Identification
 Technical Data (Weight & dimensions)
 Basic Guidelines for Installation and Set-up
 Pre-Operation Inspection
 How to Operate the Allied Work Tool
 Maintenance Schedule
 N2 Gas Charging Instructions
 Tool and Guide Bushing – Lubrication, Inspection, Wear Limits and Replacement
 Troubleshooting
 Removal From Carrier, Transporting, Lifting & Storage

1.0 Introduction and Scope – [cont'd]

1.3 Related Publications – cont'd

1.3.2 Repair Manual - 572591

The Repair Manual has been prepared to assist the Service Technician with the information necessary for the disassembly & reassembly of the Breaker. Content includes:

- Safety Information
- Disassembly & Reassembly
- Bolt Torque Specifications
- Wear Limits of Parts
- Accumulator N2 Gas Charging Instructions
- Bushing Replacement

1.3.3 AEM Safety Manual for Hydraulic Breakers

The Association of Equipment Manufacturers offers a safety manual designed for operators and maintenance personnel of hydraulic mounted breakers. The manual is available in Spanish, French and English. It is published in an illustrated format of sensible do's and don'ts, featuring typical daily situations on the job site. Content includes safety tips concerning the workplace and equipment, start up and shut down guidelines and special operating and maintenance precautions.

This publication is available by contacting:

Association of Equipment Manufacturers
Toll free 1-866-AEM-0442
E-mail: aem@aem.org
Website: www.aem.org

Ask for FORM CMHB-1004, Hydraulic Mounted Breakers.

This publication is also available through Allied under part number 953076 (English). To order a copy, contact the Allied Customer Service Department.

2.0 Equipment Identification

2.1 Model and Serial Number Location

Refer to Figure 2-1. The Serial Number assigned to this equipment can be found in the following locations:

1. Located on the Equipment Identification Tag
2. Stamped on the Valve Housing

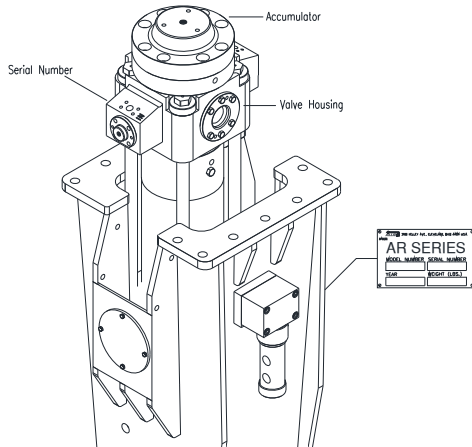

2.2 Equipment Identification Tag

The Equipment Identification Tag is affixed to the side of the housing.



Fig 2-1 Equipment Identification Tag

The ID Tag provides the following information:

- Allied Logo
- Street Address, City, State - USA
- Product name
- Model number
- Serial number
- Year of manufacture
- Weight

Confirm that the information contained on the Tag corresponds with the information provided in Section 1, Table 1.1.

2.3 Owner's Record of the Equipment

Your local Allied dealer requires complete information about the equipment to better assist you with questions regarding parts, warranty, operation, maintenance, or repair.

- Copy the Model and Serial Number from the Equipment Identification Tag to the space provided below.
- Indicate the date in which the Allied equipment was placed into service.
- Fill out the Warranty Registration form and return to Allied Construction Products, LLC.

"AR" Model AR120B

Part Number: 572410

Serial Number: _____

In Service Date: _____







Registration Date _____

3.0 Safety, Information & Identification Labels

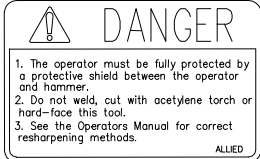

3.1 Label Description and Location On Equipment

Labels affixed to the Allied equipment communicate important information. Safety labels alert personnel to potential hazards. Other labels provide product identification and instructions important to operation and service.

Keep labels clean so that words and illustrations are legible. Replace damaged or missing labels before operating this equipment. Refer to Table 3.1 for ordering information. Refer to Figure 3-15 for the position of the label on the equipment.

Figure	Label	Description
3-1		Read The Manual - Safety Alert Symbol with pictogram of open book. Gives notice of the importance of reading the manual(s) for information and/or instructions.
3-2		Keep Clear - Pictogram displays arrow distancing worker safely from recognized hazard which is represented by the box. Breakers, or any other work tool, pose risk of injury to workers if they are not kept at a safe distance. Never operate the work tool with workers inside the work zone.
3-3		Flying Debris Hazard – Alerts personnel to the hazard of fragments becoming projectiles. A protective guard to shield the operator must be installed before operation of the breaker. Personnel are directed to the Operator’s Manual for safety instructions. NOTE: A smaller sized version of this decal is to be displayed in a conspicuous location inside the operator’s cab.
3-4		Personal Protection Equipment / Tool Re-sharpening – Alerts personnel to provide protective shielding between the operator and breaker. It also warns against welding, cutting, or hard-facing the tool. Personnel are directed to the Operator’s Manual for approved re-sharpening methods.
3-5		Pressurized Nitrogen Accumulator – Alerts personnel to the accumulator, warning of nitrogen gas under pressure. Directs personnel to the Operation and Maintenance Manual for service instructions.
3-6		Maximum Pressure – Alerts personnel the maximum operating pressure.
3-7		Lift Point – Pictogram of hook identifies approved lift points.

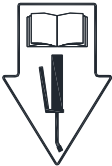
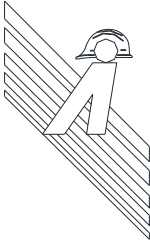
3.0 Safety, Information & Identification Labels

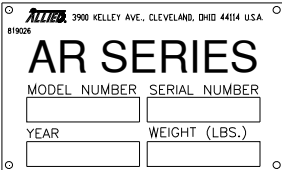
Figure	Label	Description
3-8		LUBRICATION – Decal provides re-lubrication frequency. Risk of equipment damage through unapproved methods. Strict attention to all procedures must be followed. Stand breaker upright with contact pressure applied at tool. OK to lube.
3-9		Lubrication Point – Pictogram of instruction manual and grease gun is used to identify lubrication points. Read the manual(s) for application instructions, grease type and re-lubrication schedule.
3-10		Allied “A” with Hard Hat and Background Stripes
3-11		ALLIED LOGO – This decal is the Allied brand identifier and is a registered trademark of Allied Construction Products, LLC.
3-12	AR120B	MODEL – Decal identifies the series and specific model.
3-13		OIL SUPPLY LINE “PRESSURE” I.D. TAG – A red colored cable tie marked “PRESSURE LINE” is attached to the supply hose for ease of identification between hoses.
3-14		ID TAG - Contains identifying information about the equipment, including: Manufacturer’s name, address, product name, model number, serial number, year of manufacture, and weight.

3.0 Safety, Information & Identification Labels

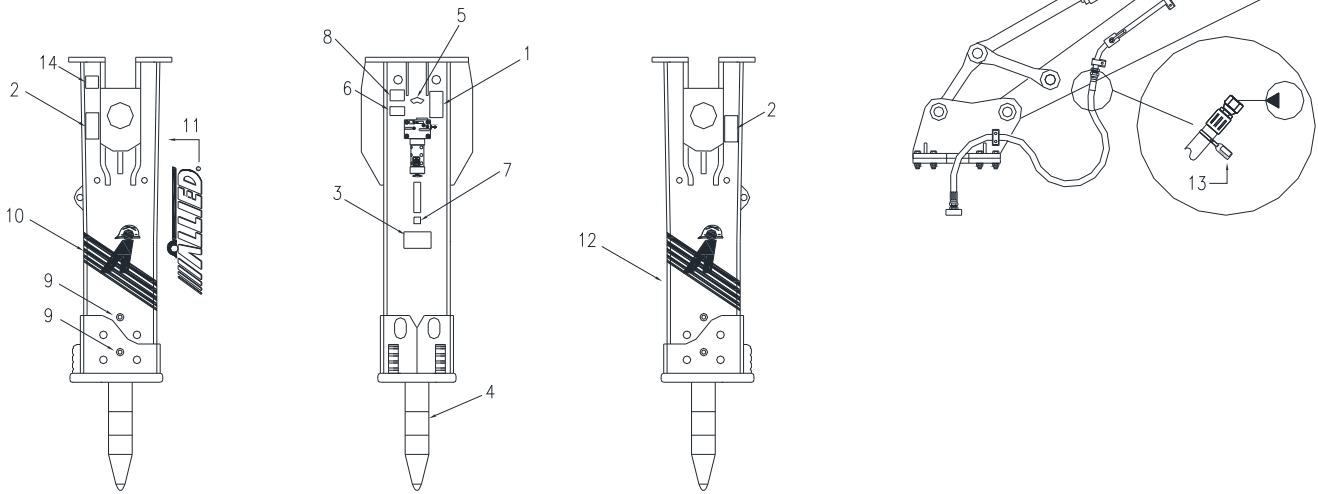

Fig. 3-15 Label Position on Equipment

Table 3.1 Decal Set

Item	Part No.	Description	Qty	Remarks / Specifications
---	572405	Decal Set	1 (SET)	SET includes 1-11, 13,14
1	676984	Decal – Read Instructions	1	
2	657841	Decal – Stay Clear	2	
3.1	657839	Decal – Danger (Small)	1	Place in conspicuous location inside cab
3.2	657840	Decal – Danger (Large)	1	
4	657838	Decal – Tool Sharpening	1	
5	102756	Decal – Warning Pressurized Accumulator	1	
6	659102	Decal – Max Operating Pressure	1	
7	676982	Decal – Lift Point	1	
8	677334	Decal – Lube w/ Tool In	1	
9	A101725	Lubrication Points	2	
10	576282	Decal – Allied “A” with Hard Hat / Stripes	2	
11	576291	Decal – Allied	1	
12	572512	Decal – Model AR120B	1	
13	818676	Pressure ID Tag	1	Attach to pressure line
14	819026	Equipment ID Plate	1	Item 14 not included in SET

4.0 Parts Information

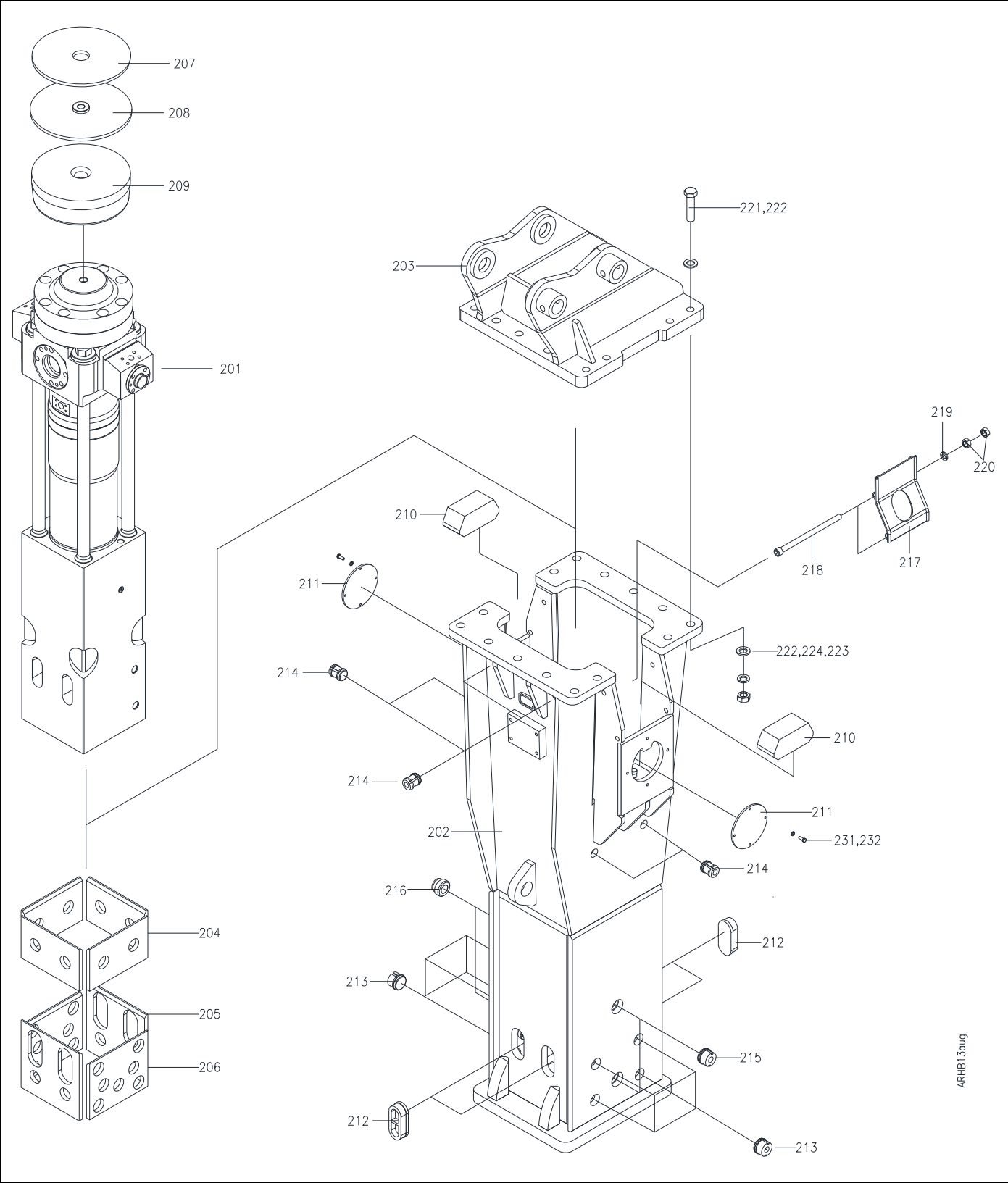

Fig. 4-1 Housing Box & Components

4.0 Parts Information – [cont'd]**Table 4.1 Housing Components (*Standard Configuration)**

Item	Description	Part No.	Qty	Remarks / Specifications
---	Std AR120B Breaker & Housing	572410	---	Item 203 not included. Order Mounting bracket separately.
201	Breaker Ass'y	---	1	Refer to Section 4.2
202	Housing	572404	1	
203	Mounting Bracket	Varies	---	Not included. Refer to Section 7
204	Wear Plate	572474	4	
205	Wear Plate	572409	2	F / R
206	Wear Plate	572475	2	L / R Sides
207	Top Wear Plate	572408	1	
208	Top Buffer Plate Ass'y	572407	1	
209	Top Buffer	572406	1	
210	Side Buffer	101517	2	
211	Cover - Steel	573165	2	
211	Cover – Rubber (Old)	570996	2	Early units
212	Rubber Plug	571767	4	
213	Rubber Plug	572390	8	
214	Rubber Plug	570998	6	
215	Rubber Plug - Grease	575360	2	With thru hole
216	Rubber Plug	B3200050	2	
216	Wear Pin (Old)	572389	2	
217	Port Cover	570994	2	
218	Socket Head Bolt	571768	4	
219	Washer	575257	4	
220	Hex Nut	607264	8	
221	Bolt	---	---	Mounting Hardware Items 221,222,223,224 Refer to Table 7.1
222	F-Washer	---	---	
223	Nut	---	---	
224	L-Washer	---	---	

4.0 Parts Information – [cont'd]

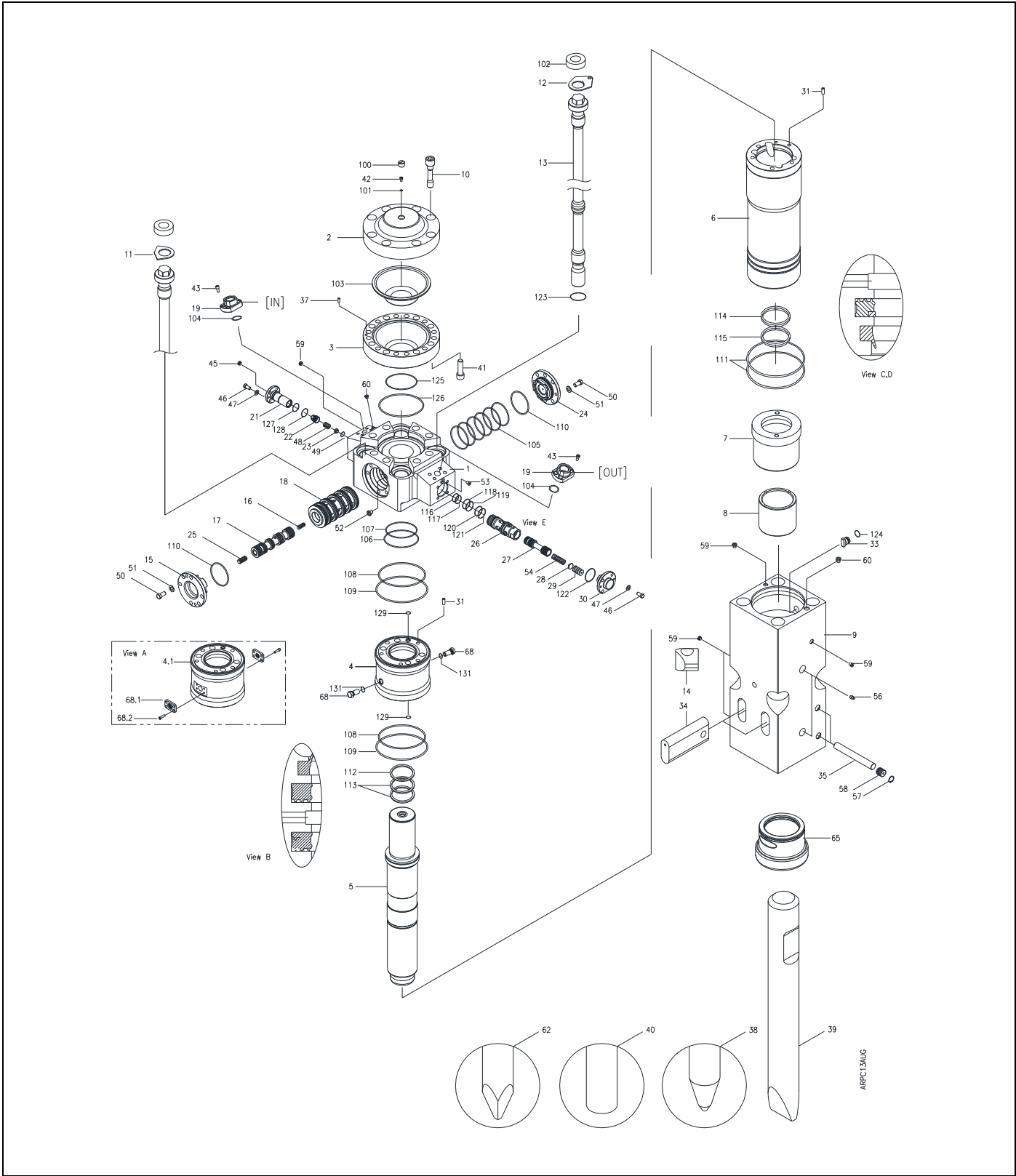

Fig. 4-2 Breaker Assembly

4.0 Parts Information – [cont'd]**Table 4.2 Breaker Assembly**

Item	Description	Part No.	Qty	Remarks / Specifications
1	Valve Housing	572476	1	
2	Accumulator Cover	572477	1	
3	Accumulator Bottom	572478	1	
4	Seal Housing	572491	1	W/Plug vent (new). Fig. 4.1 W/Flange vent (Old)
5	Piston	572489	1	
6	Cylinder	572490	1	
7	Thrust Ring	572492	1	
8	Upper Tool Bushing	572493	1	
9	Front Head	572494	1	
10	Socket Head Bolt	572479	8	Accumulator Top Position
11	Lock Plate	572480	3	
12	Lock Plate w/ Hole	572481	1	
13	Side Rod	572482	4	
14	Side Rod Nut	572495	4	
15	Sleeve Cover 1	572483	1	
16	Spool	101863	1	
17	Main Spool	102012	1	
18	Sleeve	102069	1	
19	Flange Adapter	572705	2	Refer to Table 4.3
20	---	---	---	
21	Check Valve Housing	102108	1	
22	Check valve Spool	102109	1	
23	Check Valve Spring Guide	102204	1	
24	Sleeve Cover 2	572484	1	
25	Spool	101862	1	
26	Oper Valve Guide	572485	1	
27	Oper Valve Spool	572486	1	
28	Oper Valve Spring Guide	A101846	1	
29	Shim	101854	1	
30	Oper Valve Cover	101855	1	
31	Guide Pin	102545	2	
32	---	---	---	
33	Wedge	A102558	1	
34	Tool Pin	572496	2	
35	Bushing Pin	572497	2	

4.0 Parts Information – [cont'd]

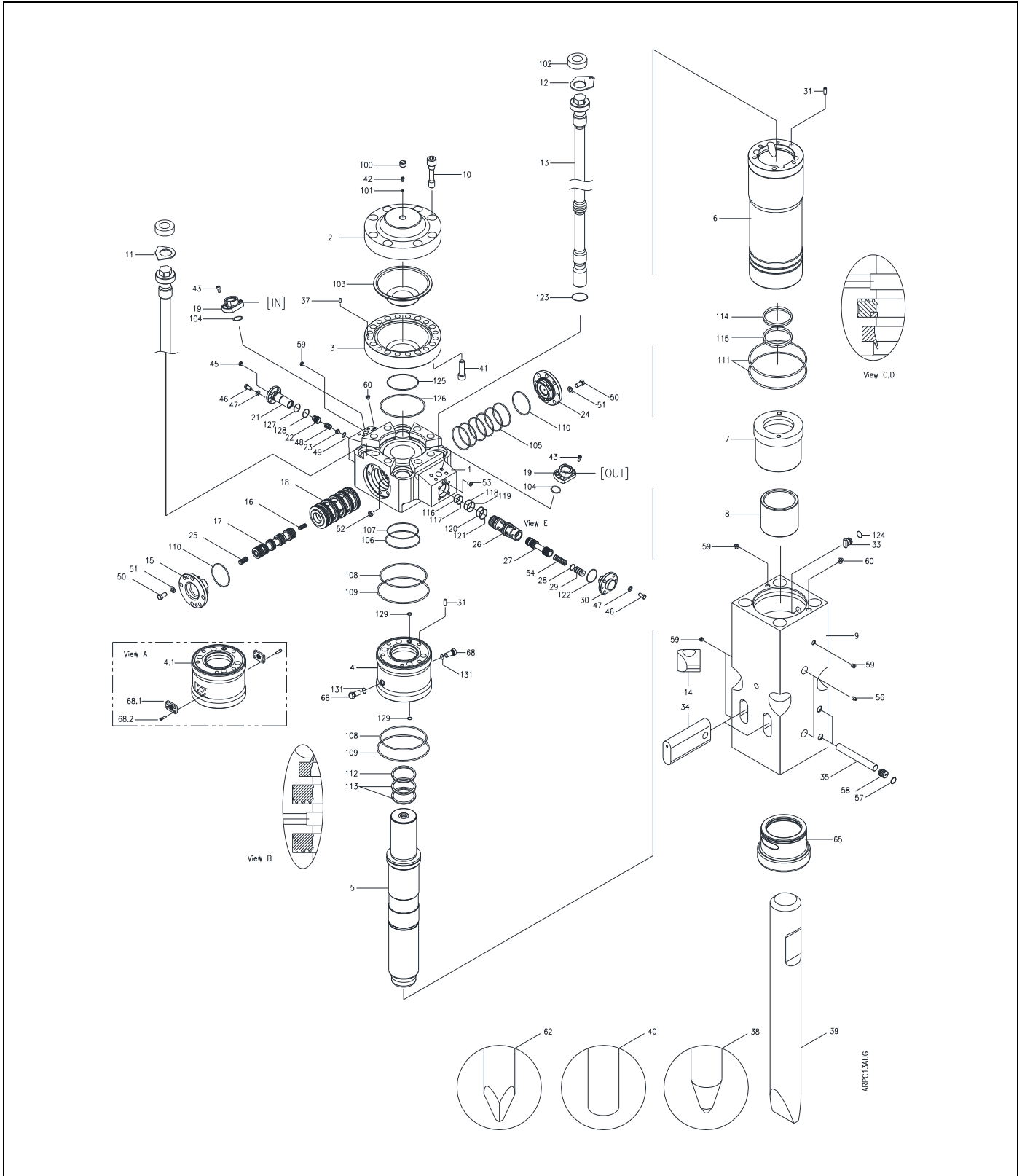

Fig. 4-2 Breaker Assembly

4.0 Parts Information – [cont'd]**Table 4.2 Breaker Assembly - (cont'd)**

Item	Description	Part No.	Qty	Remarks / Specifications
36	---	---	---	
37	Guide Pin	676183	1	
38	Tool Selection	Varies	---	38,39,40,62 Refer to Tool Selection Table 5.1
41	Socket Head Bolt	102426	12	Accumulator Bottom Position
42	Gas Bolt	676161	1	
43	Socket Head Bolt	90564	8	M12
44	---	---	---	
45	Flg Plug	676159	1	
46	Hex Head Bolt	900023	4	
47	Washer	571054	4	
48	Check Valve Spring	102212	1	
49	Lock Ring	102217	1	
50	Hex Head Bolt	571797	12	
51	Washer	571798	12	
52	Flg Plug	676216	1	
53	Flg Plug	102241	2	
54	Spring	101856	1	
55	---	---	---	
56	Grease Nipple	816675	2	
57	Snap Ring	571801	2	
58	Rubber Plug	571800	2	
59	Flg Plug	676159	2	
60	Flg Plug	102241	2	
61	---	---	---	
62	Tool Selection	Varies	---	Section 5.1
63	---	---	---	Option not available
64	---	---	---	
65	Lower Bushing	572498	1	w/O-ring (Old)
66	---	---	---	Option not available
67	---	---	---	Option not available
68	Air Vent Plug	B2006870	2	View A
68.1	Air Vent Flange Cover	102549	2	View A-(Old)
68.2	Socket Head Bolt	940587	8	View A-(Old)

4.0 Parts Information – [cont'd]

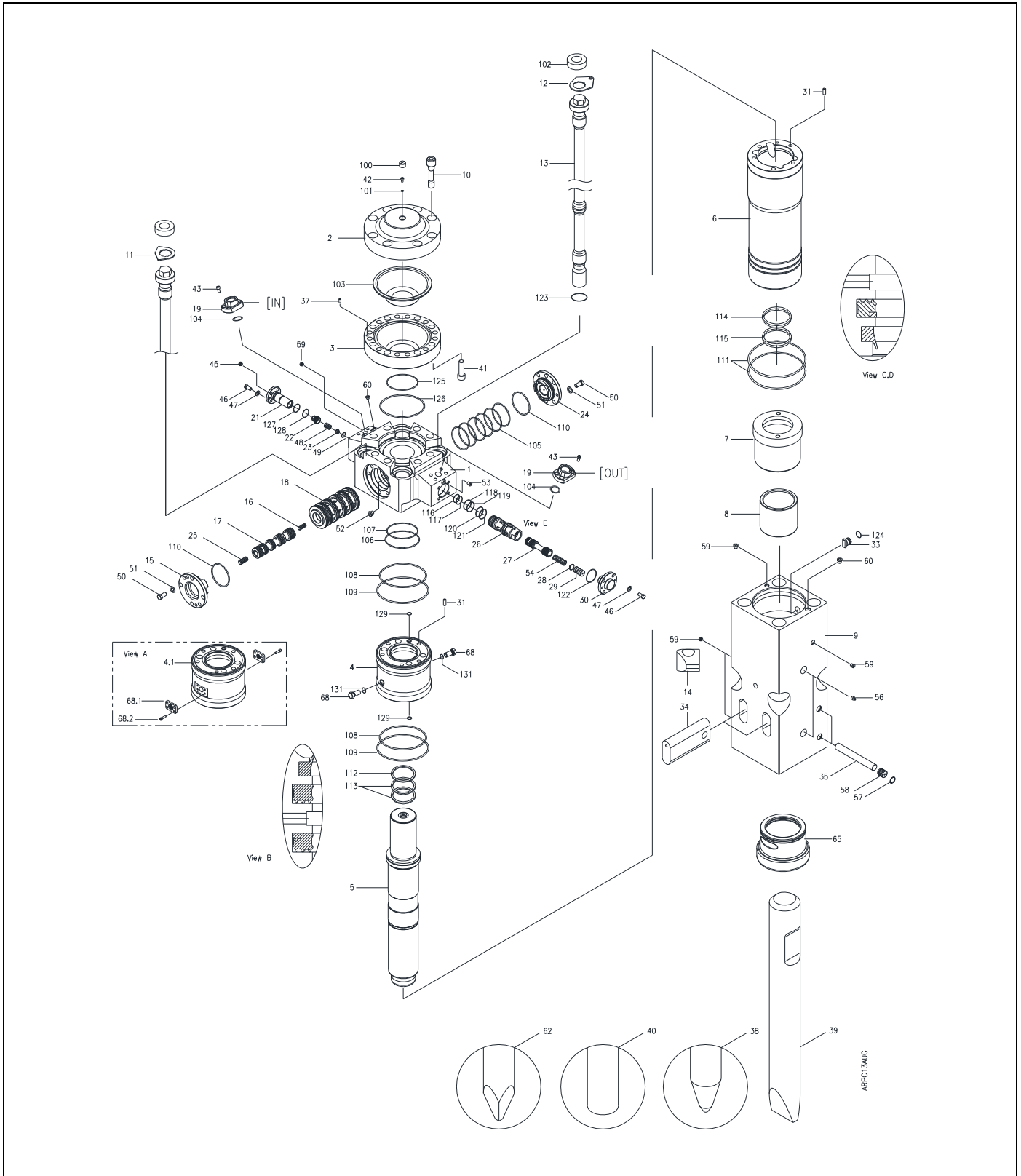

Fig. 4-2 Breaker Assembly

4.0 Parts Information – [cont'd]**Table 4.2 Breaker Assembly - (cont'd)**

Item	Description	Part No.	Qty	Remarks / Specifications
100	Cap	102262	1	
101	Usit-Ring	676201	1	
102	Rubber Ring	572487	4	
103	Membrane	101784	1	
104	O-Ring	677977	2	
105	O-Ring	A102329	6	
106	O-Ring	572501	1	
107	Back-up Ring	572502	1	
108	O-Ring	572503	2	
109	Back-up Ring	572504	2	
110	O-Ring	676202	2	
111	O-Ring	572505	2	
112	Wiper	572506	1	
113	Seal	572507	2	
114	Seal	572508	1	w/anti-extrusion ring – View C,D-(Old)
115	Wiper	572509	1	
116	Back-up Ring	101790	1	
117	O-Ring	101781	1	
118	O-Ring	676251	1	
119	Back-up Ring	101789	1	
120	O-Ring	100109	1	
121	Back-up Ring	101788	1	
122	O-Ring	676203	1	
123	O-Ring	572529	8	
124	Back-up Ring	676200	1	
125	O-Ring	101839	1	
126	Back-up Ring	101840	5	
127	O-Ring	676206	1	
128	O-Ring	676245	1	
129	O-Ring	572510	2	
131	O-Ring	572511	1	Use on 65 (Old). If 65 (New) use is discontinued

4.0 Parts Information – [cont'd]

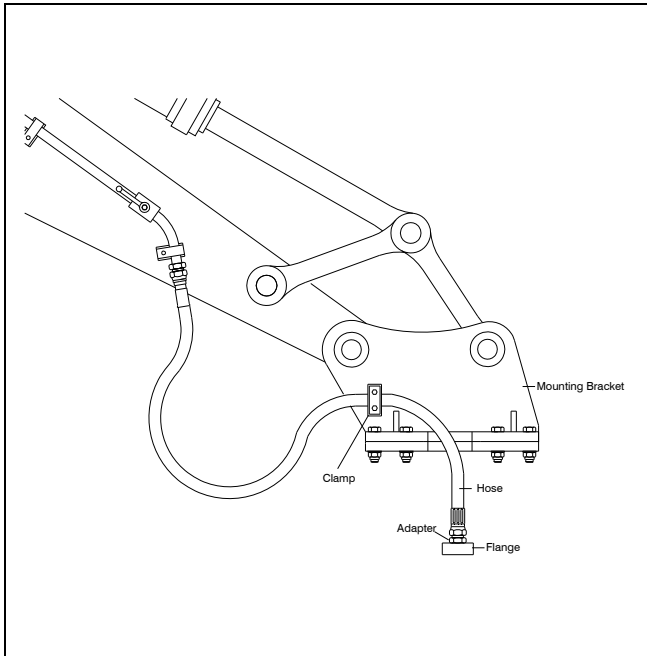

Fig. 4-3 Hose Routing To Excavator - Typical

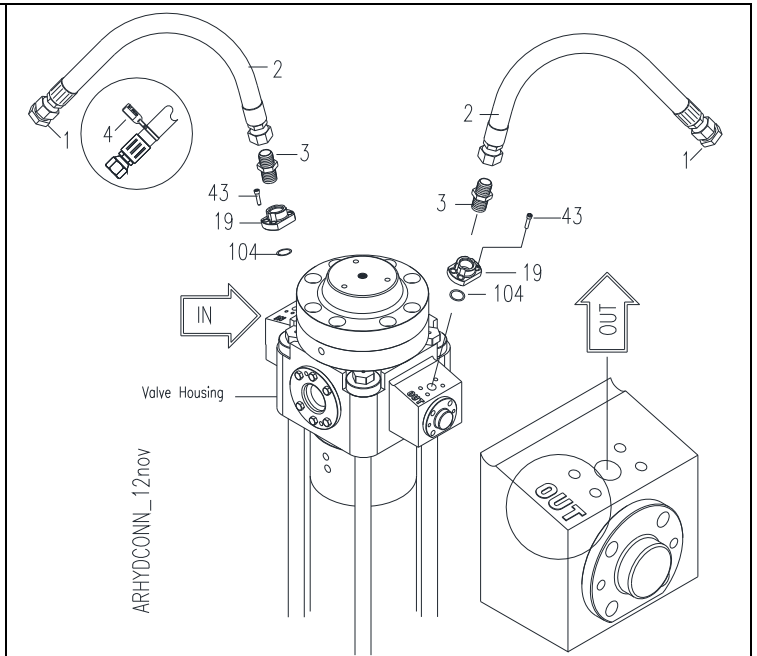

Fig. 4-4 Hydraulic Connections

Table 4.3 Hydraulic Connections (*Standard Configuration Shown)

Item	Description	Part No.	Qty	Remarks / Specifications
1	Plug	814454	2	16JIC
2	Hose	659530	2	
3	Adapter	656745	2	16SORB
4	Pressure ID Tag	818676	1	Attach to Pressure Line [IN]
19	Flange Adapter	572705	2	1" (16) [IN], [OUT]
43	Socket Head Bolt	90564	8	M12
104	O-Ring	677977	2	

5.0 Tool Selection Guide

5.1 Standard Tools

The three most commonly used tools for concrete demolition, rock cutting and boulder reduction are the Chisel, Conical and Blunt.

A. Chisel (Wedge – Cross Cut or In-Line) – Suitable applications include soft rock and general demolition of concrete. The tool penetrates into the material, forcing it to separate. Useful when cutting action is required, e.g. benching and trenching.

B. Conical Point - Same applications as the chisel. The conical tool also penetrates, but unlike the chisel, the rounded shape resists twisting that can cause burring in the tool's retainer pin area.

C. Blunt Tool – Designed for impact breaking. The blunt tool is effective in secondary breaking of oversize rock or boulder reduction.

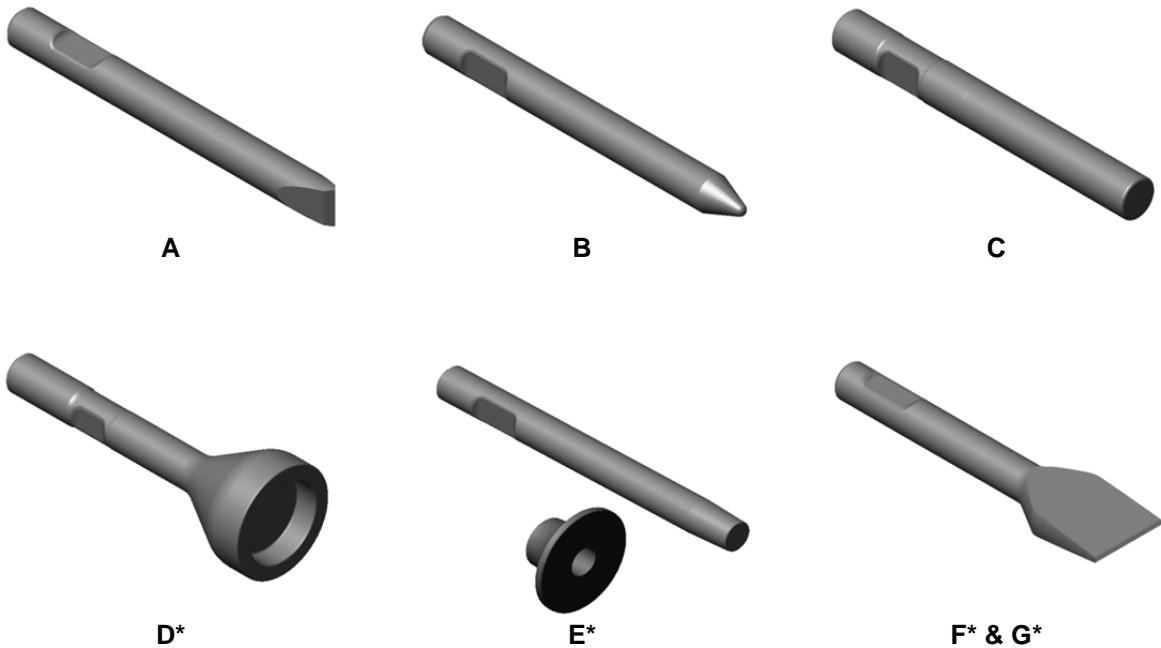

Fig. 5-1 Standard and Specialty Tools
(*Shown are general illustrations. Actual tool design may vary)

5.2 Specialty Tools (*Not available for all models).

Specialty tools have a specific purpose or function designed into each tool. These tools can extend the versatility of a breaker, thus increasing productivity and eliminating the need for additional equipment.

- D. Post Driver** – For driving posts, pipes, etc.
- E. Tamper** – Designed to compact loose material.
- F. Frost Cutter** – For cutting into frozen ground.
- G. Asphalt Cutter** – Designed to cut seams in asphalt for removal. Useful when removing asphalt to dig a trench. Available in Cross-Cut and In-Line configurations.

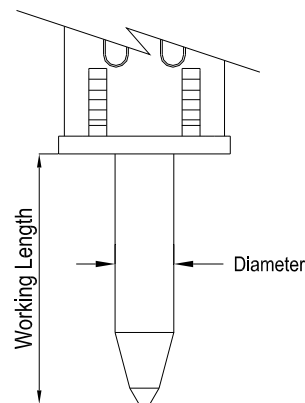

Fig. 5-2 Tool Diameter & Working Length

5.0 Tool Selection Guide

Table 5.1 Standard Tools

Item	Description	Part No.	TD ³⁾ x WL ⁴⁾ in. (mm)	Weight – lbs. (kg)
34-B	Conical Point	572513	4.72 [120] x 25 (638)	187 (85)
35-A¹	Chisel Cross Cut	572514	4.72 [120] x 25 (638)	187 (85)
---	Chisel In-Line	---	---	---
36-C	Blunt End	572515	4.72 [120] x 21 (538)	165 (75)
37	Pyramid (Not Pictured)	---	4.72 [120] x 25 (638)	187 (85)

¹⁾ **Standard tool supplied with breaker**

²⁾ For availability of tool types not listed, contact Allied

³⁾ TD - Tool Diameter

⁴⁾ WL - Working Length

5.3 Allied Chisel Paste

A key element in improving the wear resistance of the bushing and tool is through the regular use of a high-quality lubricant. Allied Chisel Paste is a "specialty" lubricant, formulated for use in heavy loaded, sliding (reciprocating) motion and high heat applications. Allied Chisel Paste performs exceptionally well in this application because of its "unique blend" of liquid and solid lubricants.

Solid lubricants, which include particles of molybdenum, copper and graphite, form a highly effective structure that resist against being squeezed out during periods of heavy loading.

"General / Multi-Purpose" grease typically contain modest amounts of solid lubricants if any at all. When the tool is loaded against the bushing, the liquid lubricant is squeezed out until nothing is left. The result is metal-to-metal contact, which quickly leads to friction related wear and damage.

5.3.1 Packaging & Ordering Information

Table 5.2 Chisel Paste

Container	Packaging	Part No.
14.5 oz. Cartridge*	Qty x 10	574430
14.5 oz. Cartridge*	Qty x 30	574431
35 lbs. Bucket	Qty x 1	676698
120 lbs. Drum	Qty x 1	679968

*Cartridge fits standard hand-type grease gun

6.0 Service Kits and Tools

6.1 Tune-up Kit

All breakers require regular maintenance and periodic parts replacement. Follow the recommended service schedule to maintain reliable service.

Tune-up kits can help restore performance by replacing common wear parts. Tune-up kits offer the convenience of combining parts that usually need to be replaced at the same time into one pre-packaged kit.

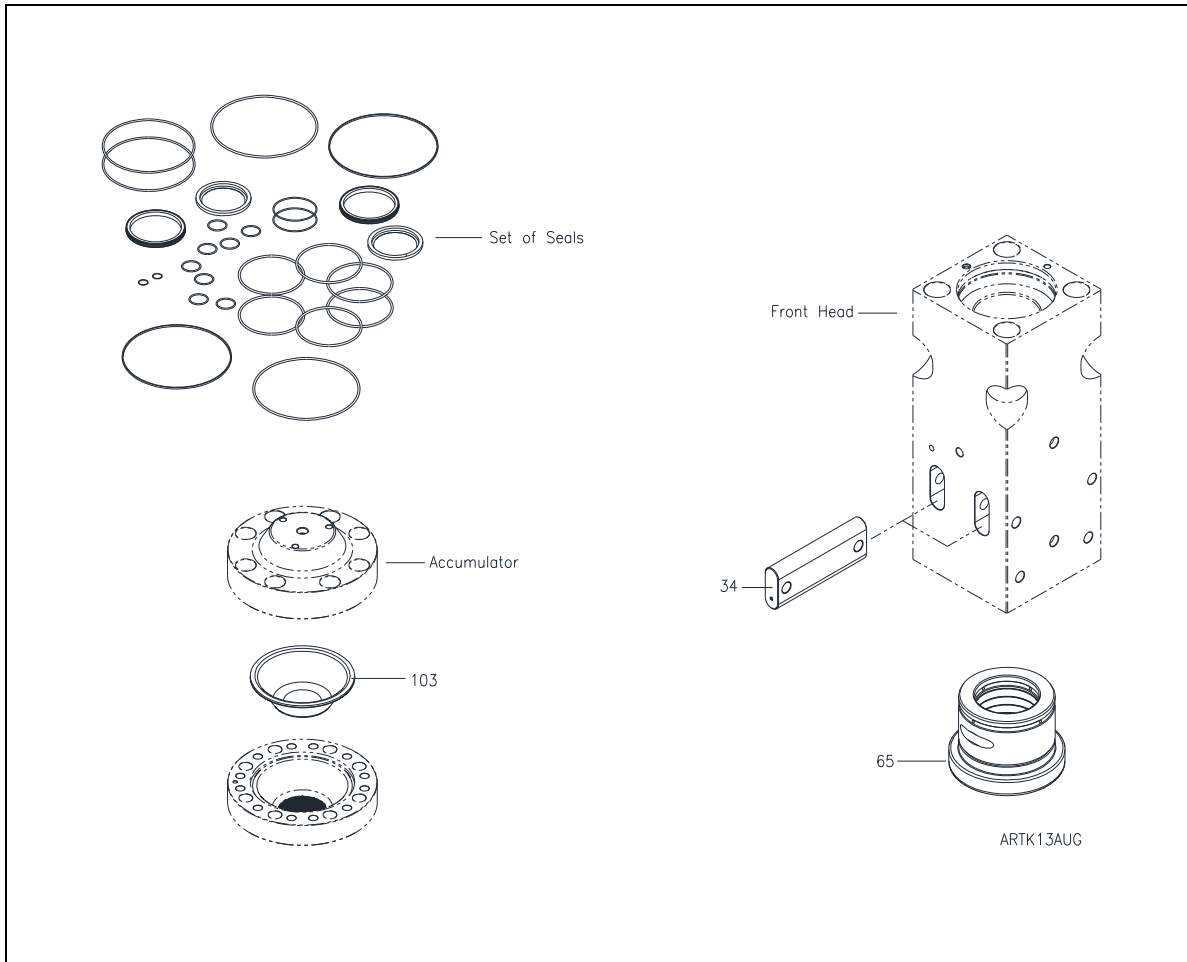

Fig. 6-1 Tune-up Kit

Table 6.1 Tune-up Kit

Item	Description	Part No.	Qty	Remarks / Specifications
---	Tune-up Kit	572488	1-Kit	Kit Includes Seal Kit & Items 34,65,103
---	Seal Set	572516	1	
34	Tool Pin	572496	2	
65	Lower Tool Bushing	572498	1	
103	Accumulator Membrane	101784	1	

6.0 Service Kits and Tools – [cont'd]

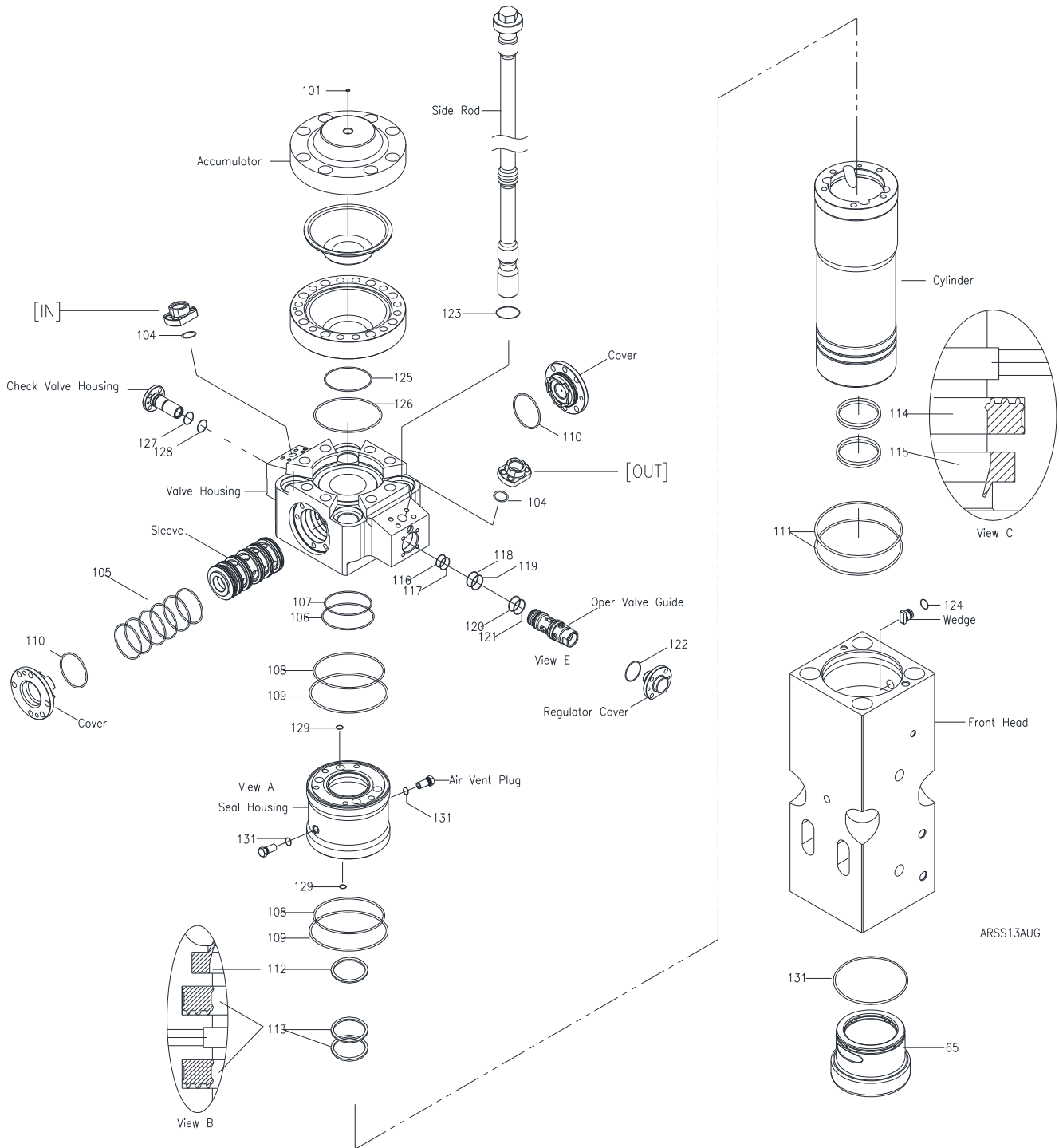

Fig 6-2 Seal Positions (AR120B Seal Set – 572516)

6.0 Service Kits and Tools – [cont'd]**Table 6.2 Seal Set**

Pos	Description	Part No.	Qty	Remarks / Specifications
---	Seal Set	572516	1-Set	Set Includes All Items Listed In Table 6.2
101	Usit-Ring	676201	1	
103	Membrane	101784	1	
104	O-Ring	677977	2	
105	O-Ring	A102329	6	
106	O-Ring	572501	1	
107	Back-up Ring	572502	1	
108	O-Ring	572503	2	
109	Back-up Ring	572504	2	
110	O-Ring	676202	2	
111	O-Ring	572505	2	
112	Wiper	572506	1	
113	Seal	572507	2	
114	Seal	572508	1	w/anti-extrusion ring – View C,D (Old)
115	Wiper	572509	1	
116	Back-up Ring	101790	1	
117	O-Ring	101781	1	
118	O-Ring	676251	1	
119	Back-up Ring	101789	1	
120	O-Ring	100109	1	
121	Back-up Ring	101788	1	
122	O-Ring	676203	1	
123	O-Ring	572529	4	Was 2 per side rod (Old)
124	O-Ring	676200	1	
125	O-Ring	101839	1	
126	Back-up Ring	101840	1	
127	O-Ring	676206	1	
128	O-Ring	676245	1	
129	O-Ring	572510	2	
131	O-Ring	676209	2	
132	O-Ring	572511	1	Use on 65 (Old). If 65 (New) use is discontinued
---	Thread Lube 2 oz.		1	Follow application instructions

IMPORTANT

Contamination interferes with reliable operation and will shorten component life. Always work in a clean area. Keep seals properly stored in their original sealed package until ready for use.

IMPORTANT

Lubricant provided with seal set is applied to side rod threads. **DO NOT** apply to seals!

6.0 Service Kits and Tools – [cont'd]

Fig 6-3 Detail View of Seal Positions (AR120B Seal Set – 572516)

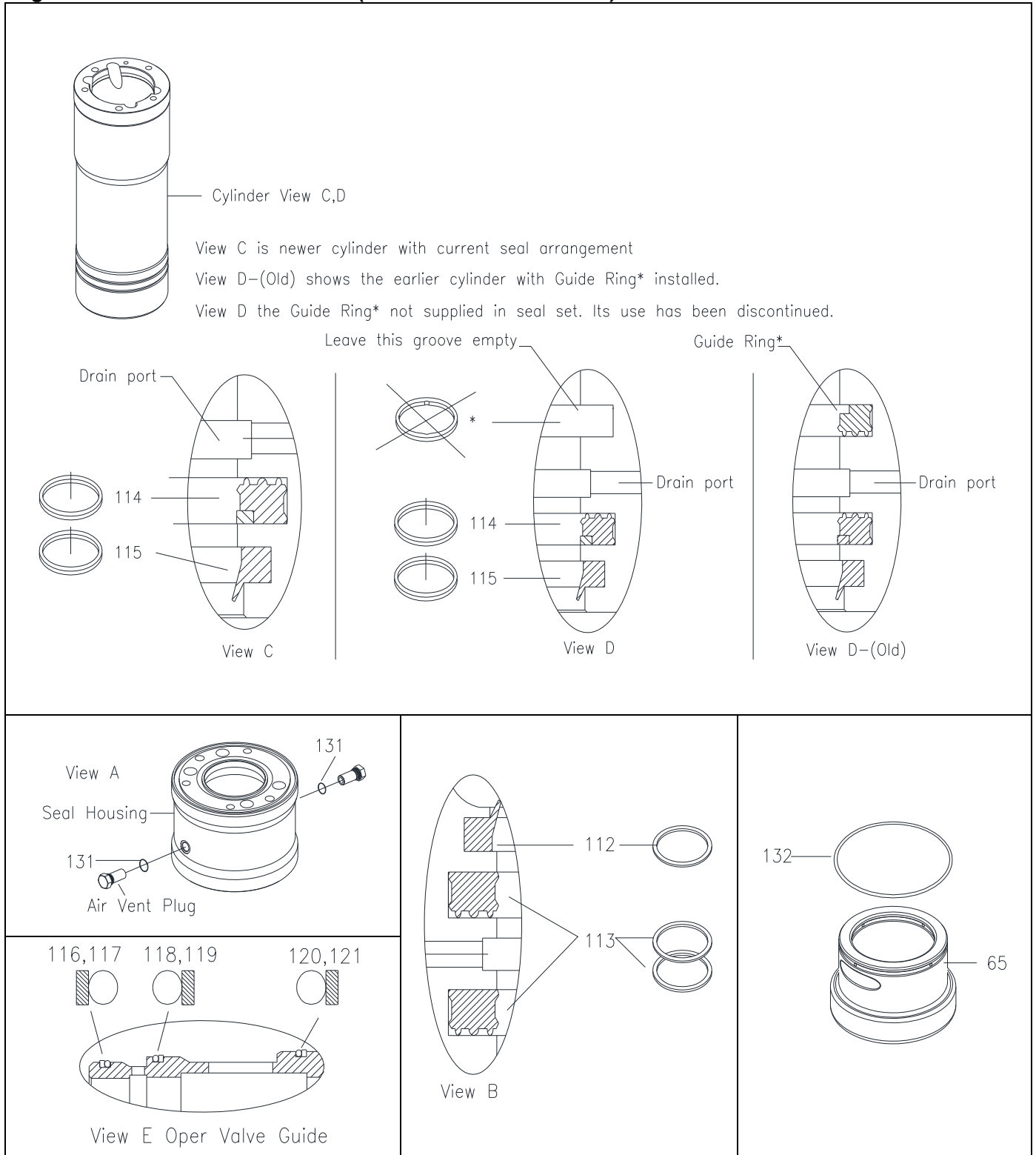

Refer to Manual 572591 for proper assembly of parts.

6.0 Service Kits and Tools – [cont'd]

6.3 Accumulator N2 Gas Charge Equipment

The accumulator is a self-contained pressure vessel with an elastic membrane dividing the inner chamber. The lower chamber is used to receive, store and discharge pressurized oil. The upper chamber is filled with nitrogen gas.

Proper function of the accumulator and optimum service life of the membrane requires accurate charging of the upper chamber. Filling is accomplished with the use of the charging tool (Fig. 6-3) and a commercially available nitrogen bottle. Components of the N2 charge kit are identified in Table 6.3.

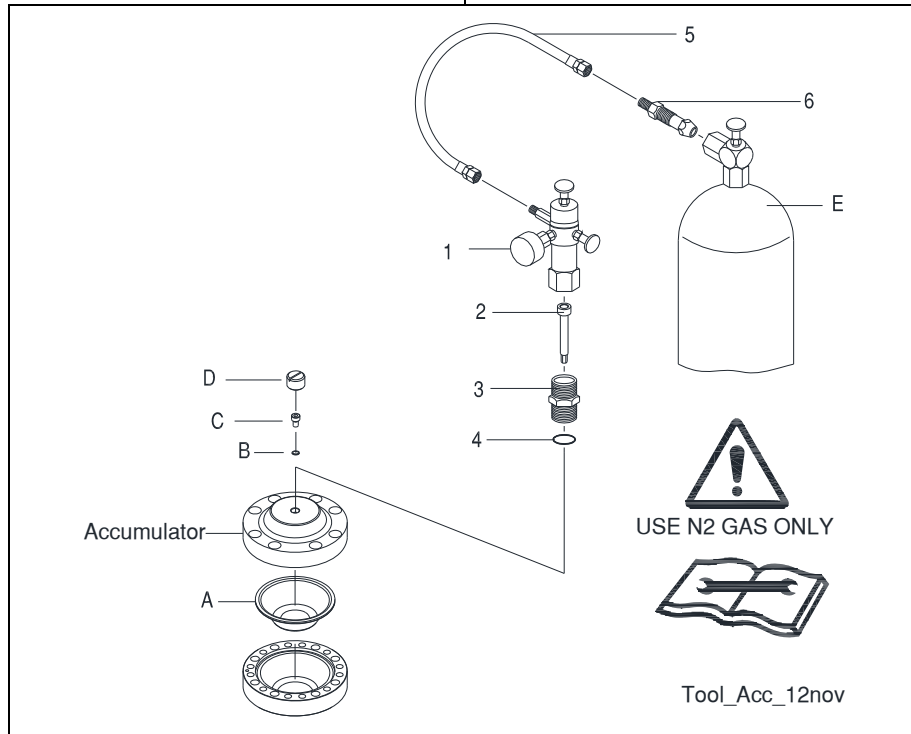



Fig. 6-3 Accumulator N2 Gas Charge Tool

Table 6.3 N2 Gas Charge Kit

Item	Description	Part No.	Qty	Remarks / Specifications
---	N2 Gas Charge Kit	570071	1-Kit	Kit includes 1,2,3,4,5,6
1	Charge Valve with Gauge	100527	1	Includes 2-6 (& storage case - not shown)
2	Socket Bolt	40601	1	
3	Adaptor	R101635	1	
4	O-ring	901135	1	
5	Hose	N/A	1	8 Ft. [2.5 M] Not Available Separately
6	Adapter for N2 Gas Bottle	N/A	1	Not Available Separately
E	Nitrogen Gas Bottle	N/A	---	Not Available from Allied (Source Locally)
A,B,C, D,E	Membrane, U-sit ring, Bolt, Cap, N2 Gas Bottle	---	---	A,B,C,D,E Shown only for reference and are not included in charge kit.

  For safe and proper use of this tool, read, understand and follow all instructions given in the Safety, Operation & Maintenance 575290

7.0 Mounting to the Carrier

7.1 Mounting Brackets

The mounting bracket (sold separately) attaches the Allied Breaker to a carrier. Allied offers an array of mounting brackets to fit virtually any carrier, including those equipped with quick mounting couplers.

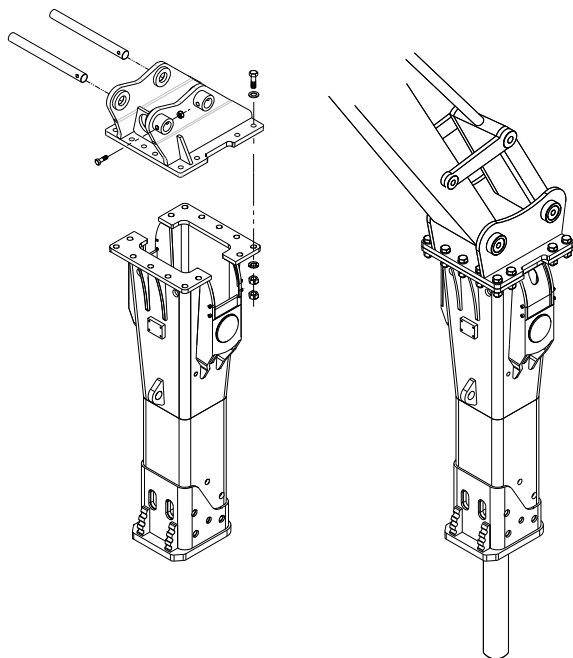

Fig. 7-1 Mounting Bracket Pin-on Type - Typical

Complete information about the carrier is required when ordering mounting brackets. This includes the make, model, series and serial number. Additional information is required if the carrier is equipped with a quick coupler.

Refer to Figure 7-1. The mounting bracket is bolted to a connection plate located at the top of the box housing. The thickness of the plate, as well as other dimensions, including the quantity, diameter and spacing of the bolt holes will vary between breaker models (Fig. 7-2).

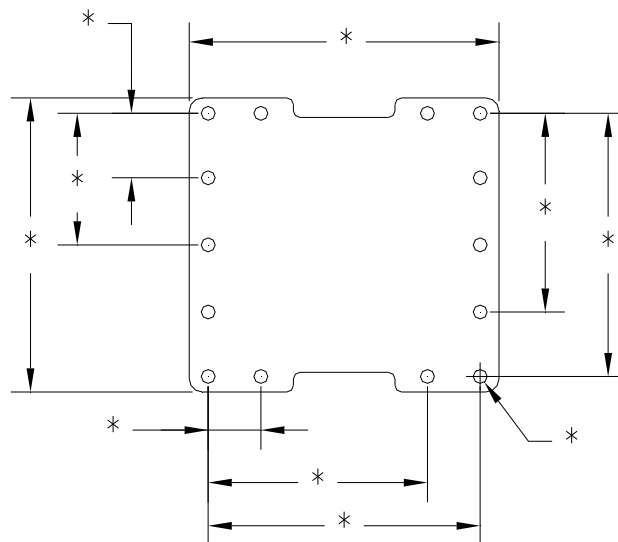

Fig. 7-2 Connection Plate Hole Pattern Family

In Table 7.1, AR breaker models are grouped by “Family”. The “Family” designates the connection plate that is welded to the housing plates, housing box and mounting brackets. Other Allied work tools, including the Ho-Pac® utilize these same mounting Families. Dimensions for these connection plates can be found in the Safety, Operation and Maintenance Manual.

Table 7.1 Mounting Family & Hardware

Family	Breaker Model	Bolt	FL Washer	LK Washer	Nut
BR	AR70C, A75B	90566 (12)	--- (0)	90597 (24)	91000 (12)
SR	AR85B, AR95B	572352 (10)	679422 (20)	571027 (10)	572353 (10)
MR	AR110B, AR110C, AR120B	101765 (14)	901291 (28)	658529 (14)	90507 (14)
LR8	AR130B, AR140B	101765 (14)	901291 (28)	658529 (14)	90507 (14)
LR9	AR160C, AR165, AR170C, AR175	573167 (14)	573029 (28)	573028 (14)	90519 (14)
LR10	AR180C, AR180D	576464 (14)	573029 (28)	573028 (14)	90519 (14)
AR205	AR205				



Tightening torque for these fasteners can be found in the Safety, Operation and Maintenance Manual 575290.

8.0 How To Order Spare Parts

Your local Allied dealer requires the Product Name, Model and Serial Number to better assist you with questions regarding parts, warranty, operation, maintenance, or repair. This information should be noted in Section 2.3 of this manual.

Product AR-Series Breaker
 Model AR120B
 Serial No. _____

Complete information is required

Line	Description	Part Number	Quantity	Price
1				
2				
3				
4				
5				
6				
7				
8				
9				
10				

Your contact information

Your Name _____ Company Name _____
 Phone _____ Account Number _____
 Fax _____ Purchase order _____
 Email _____ Shipping carrier _____

*See note below

Billing Address _____ Shipping Address _____

***Note: All backordered parts will be shipped when available via the same method as the original order unless initialed and checked below:**

Initials _____
 Ship complete order only
 Ship available parts and contact customer on disposition of backordered parts
 Other – specify below

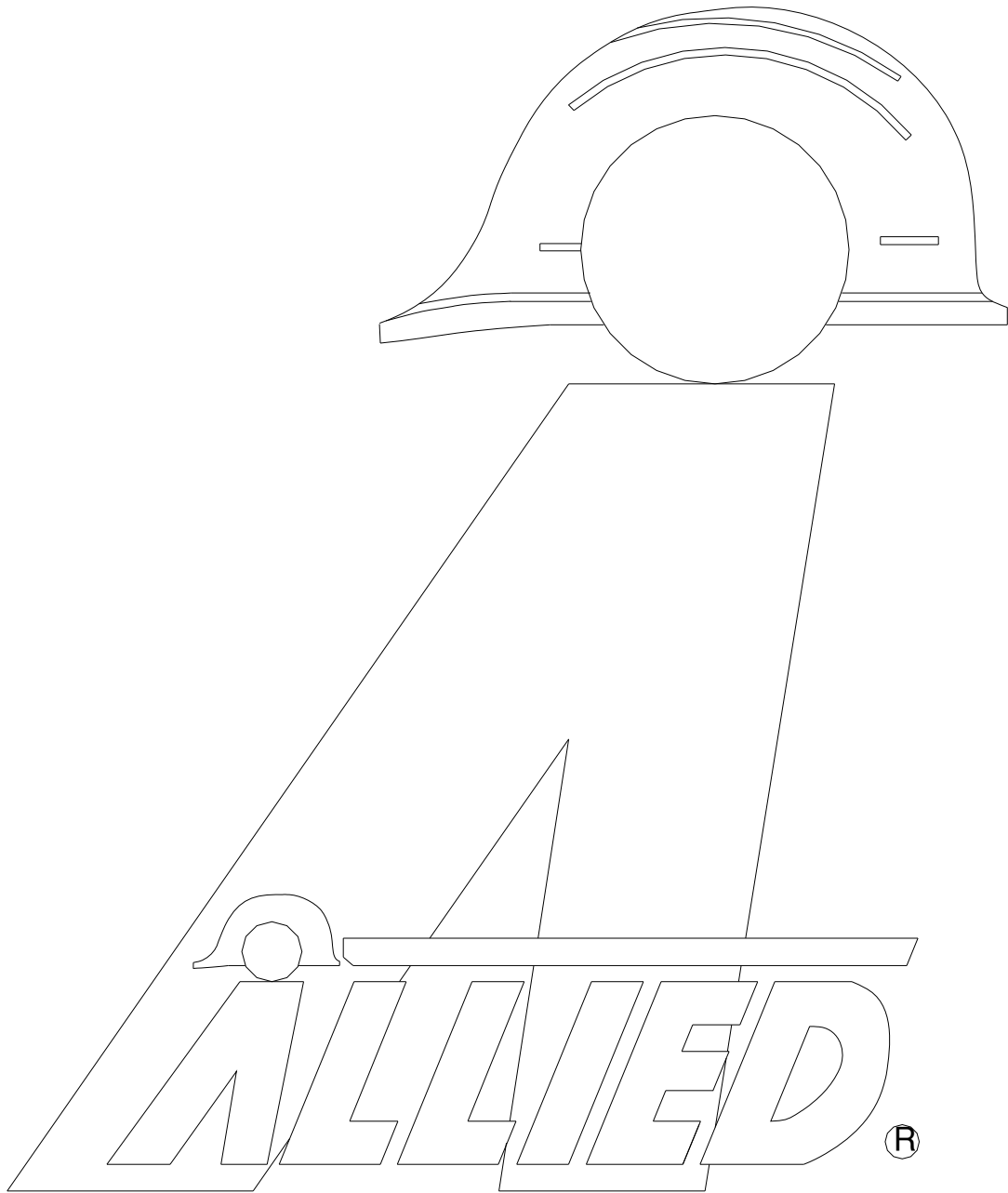

ALLIED[®]
Construction Products, LLC

3900 Kelley Avenue, Cleveland, Ohio 44114
Tel: 216-431-2600 Fax: 216-431-2601
e-mail: Sales@AlliedCP.com
website: <http://www.AlliedCP.com>